

26 421 000 TEMPESTA SYSTEM SHOWER SYSTEM WITH THERMOSTAT FOR WALL MOUNTING

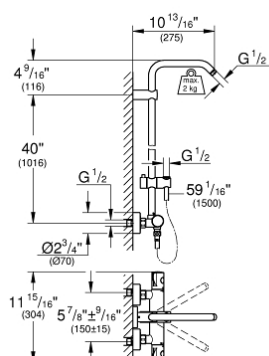

PRODUCT DESCRIPTION

- Colour: chrome
- consisting of:
 - Optional fixed or 45° swivel shower arm
- exposed thermostat with Aquadimmer function
- ADA Compliant handles
- Allows change between:
 - head shower and hand shower (not included)
- gliding element
- Rotaflex Metal Long-Life TwistStop shower hose 1.50 m (28 417)
- GROHE TurboStat Compact cartridge with wax thermoelement
- GROHE SafeStop safety button at 38°C
- GROHE SafeStop Plus optional temperature limiter at 43°C included
- GROHE Long-Life finish
- GROHE SafeStop safety button at 38°C
- Inner WaterGuide for a longer life
- TwistStop to prevent hose from twisting
- Suitable for instantaneous heaters from 18 kW/h
- minimum flow rate 7 l/min
- CALGreen compliant
- Two discrete functions (non-shared)
- protected against backflow



26 421 000 TEMPESTA SYSTEM SHOWER SYSTEM WITH THERMOSTAT FOR WALL MOUNTING

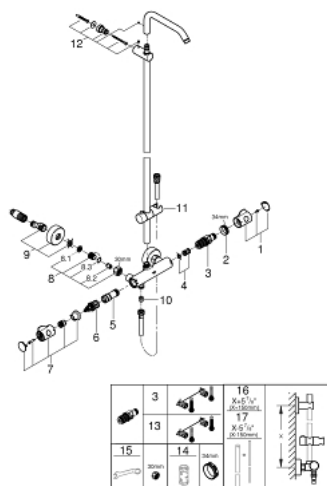

SPARE PARTS, April 2018 – spareParts.validDate.now

- 1: Temperature control handle (Order-nr. 47981000)
- 2: Fitting ring (Order-nr. 47743000)
- 3: 1/2" Thermostatic compact cartridge (Order-nr. 47885000)
- 4: Buffer (Order-nr. 47398000)
- 5: Water flow (Order-nr. 47751000)
- 6: Aquadimmer (Order-nr. 12433000)
- 7: Aquadimmer shut-off handle (Order-nr. 49056000)
- 8: Non-return valve (Order-nr. 47189000)
- 8.1: Dirt strainer (Order-nr. 0726400M)
- 8.2: Non-return valve (Order-nr. 08565000)
- 8.3: O-ring (17 x 2mm) (Order-nr. 0305500M)
- 9: S-union (Order-nr. 12662000)
- 10: Non-return valve (Order-nr. 08565000)
- 11: Glide element (Order-nr. 12140000)
- 12: Shower bar holder (Order-nr. 48423000)
- 13: GROHE TurboStat cartridge 1/2" (Order-nr. 47175000)*
- 14: Socket spanner (Order-nr. 19332000)*
- 15: Special spanner (Order-nr. 19377000)*
- 16: Shower system pipe for retrofitting (Order-nr. 48053000)
- *
- 17: Shower system pipe for retrofitting (Order-nr. 48054000)
- *
- * Optional accessories