

## 24 150 003 **ATRIO THERMOSTATIC MIXER FOR 1 OUTLET WITH SHUT OFF VALVE**



### PRODUCT DESCRIPTION

- Colour: chrome
- Set for final installation for
- Required rough-in-set sold separately (GROHE Rapido SmartBox 35 601 000)
- GROHE TurboStat Compact cartridge with wax thermoelement
- GROHE Long-Life finish
- Wall escutcheon with GROHE FastFixation (covered escutcheon and shaft sealing, covered fixing)
- metal escutcheon, retroactively 6° adjustable
- GROHE SafeStop safety button at 38°C
- GROHE SafeStop Plus temperature limiter at 115° F/46° C
- ceramic stop valve, 120°
- Metal handles
- Requires Rough-In Set (29 038 001) (sold separately)

## 24 150 003 ATRIO THERMOSTATIC MIXER FOR 1 OUTLET WITH SHUT OFF VALVE

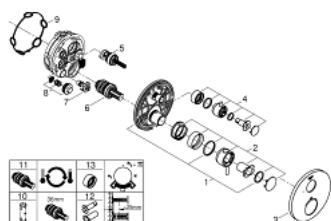

**SPARE PARTS**, January 2018 – spareParts.validDate.now

- 1: Mounting plate (Order-nr. 49080000)
- 2: Temperature control handle (Order-nr. 49089000)
- 3: Escutcheon (Order-nr. 49096000)
- 4: Aquadimmer shut-off handle (Order-nr. 49165000)
- 5: Aquadimmer (Order-nr. 49084000)
- 6: 3/4" Thermostatic compact cartridge (Order-nr. 49028000)
- 7: <strong>Service Stops</strong> (Order-nr. 1405300M)
- 8: Non-return valve (Order-nr. 49085000)
- 9: Seal (Order-nr. 48360000)
- 10: Socket spanner (Order-nr. 49059000)\*
- 11: 3/4" Reversed TurboStat Cartridge (Order-nr. 49003000)\*
- 12: Universal extension set 2-handle thermostats, 25 mm (Order-nr. 14058000)
- \*
- 13: Aquadimmer Stop Ring for Shared Function (Order-nr. 14060000)\*
- \* Optional accessories