

## 19 927 000 **EUROCUBE DUAL FUNCTION THERMOSTATIC TRIM WITH CONTROL MODULE**



### **PRODUCT DESCRIPTION**

- Colour: chrome
- For shower/tubs with non-diverter tub spout or for 2 shower outlet applications
- GROHE TurboStat technology
- Integrated volume control
- 2-way diverter function
- 1 axis operation
- Requires GrohFlex™ universal rough-In box (35 026 000) (sold separately)
- Flow rate:
- Code compliance:
- ASME/ANSI A112.18.1M
- CSA Standard B125.1-05

## 19 927 000 EUROCUBE DUAL FUNCTION THERMOSTATIC TRIM WITH CONTROL MODULE

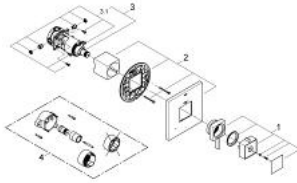

### SPARE PARTS, April 2012 – spareParts.validDate.now

1: lever US (Order-nr. 47897000)

2: escutcheon US (Order-nr. 47914000)

3: Control unit THM kit #2 (Order-nr. 47853000)

3.1: non-return valves (Order-nr. 47851000)

4: Extension for Volume Control (Order-nr. 47889000)\*

\* Optional accessories