

## 19 926 000 EUROCUBE SINGLE FUNCTION THERMOSTATIC TRIM WITH CONTROL MODULE



### PRODUCT DESCRIPTION

- Colour: chrome
- for shower only or shower/tub with diverter applications
- GROHE TurboStat technology
- Integrated volume control
- Integrated bypass option when used with diverter tub spout
- 1 axis operation
- Requires GrohFlex™ universal rough-In box (35 026 000) (sold separately)
- Flow rate:
- Code compliance:
- GROHE SilkMove
- GROHE Long-Life finish
- ASME/ANSI A112.18.1M
- CSA Standard B125.1-05

## 19 926 000 EUROCUBE SINGLE FUNCTION THERMOSTATIC TRIM WITH CONTROL MODULE

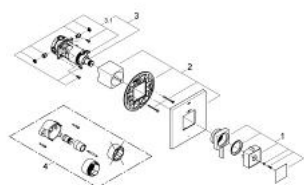

### SPARE PARTS, April 2012 – spareParts.validDate.now

1: lever US (Order-nr. 47897000)

2: escutcheon US (Order-nr. 47913000)

3: Grohflex cartridge (Order-nr. 47850000)

3.1: non-return valves (Order-nr. 47851000)

4: Extension for Volume Control (Order-nr. 47889000)\*

\* Optional accessories