

19 924 000 EUROCUBE SINGLE FUNCTION PRESSURE BALANCE TRIM WITH CONTROL MODULE



PRODUCT DESCRIPTION

- Colour: chrome
- for shower only or shower/tub with diverter applications
- Integrated bypass option when used with diverter tub spout
- Requires GrohFlex™ universal rough-in box (35 026 000) (sold separately)
- Flow rate:
- Code compliance:
- GROHE SilkMove
- GROHE LongLife finish
- ASME/ANSI A112.18.1M
- CSA Standard B125.1-05
- ADA compliant

19 924 000 EUROCUBE SINGLE FUNCTION PRESSURE BALANCE TRIM WITH CONTROL MODULE

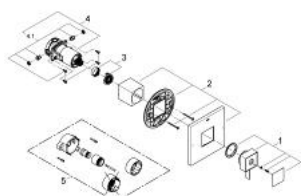

SPARE PARTS, April 2012 – spareParts.validDate.now

1: lever pressure balancing valve US (Order-nr. 47896000)

2: escutcheon US (Order-nr. 47912000)

3: handle adaptor US (Order-nr. 47863000)

4: Grohflex cartridge (Order-nr. 47857000)

4.1: non-return valves (Order-nr. 47851000)

5: Extension for Volume Control (Order-nr. 47890000)*

* Optional accessories